

All persons involved in operation or maintenance must read and understand the Safety Instructions before starting operation.

### ▼ Installation of Tag

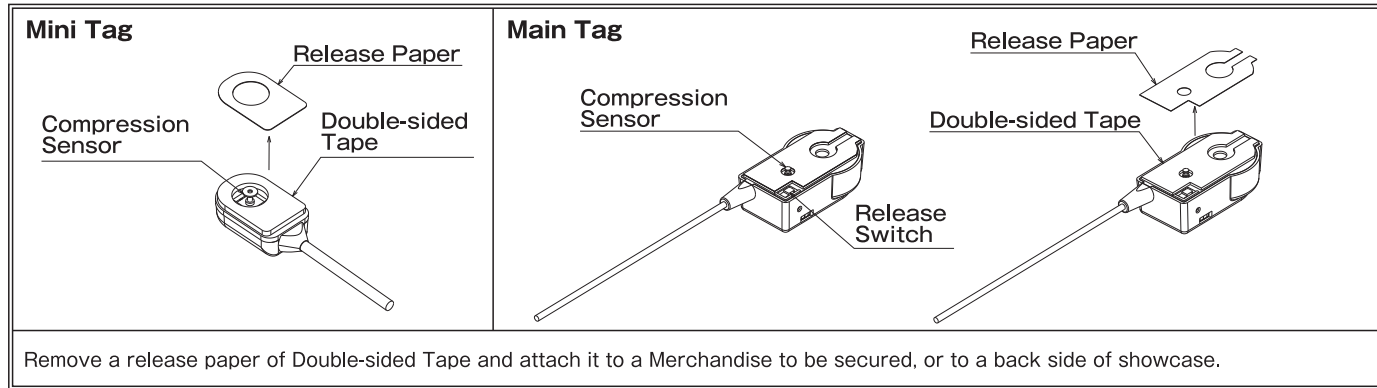

**Note :**

- \* Select flat and smooth surface for attaching Double-sided Tape.
- \* Approx. 2 hours are required to obtain a full adhesion.
- \* Once adhesive tape is removed, the adhesive power is drastically reduced. Use a new tape (Sold separately) to secure proper operation.

### ▼ Setting of Alarming Buzzer

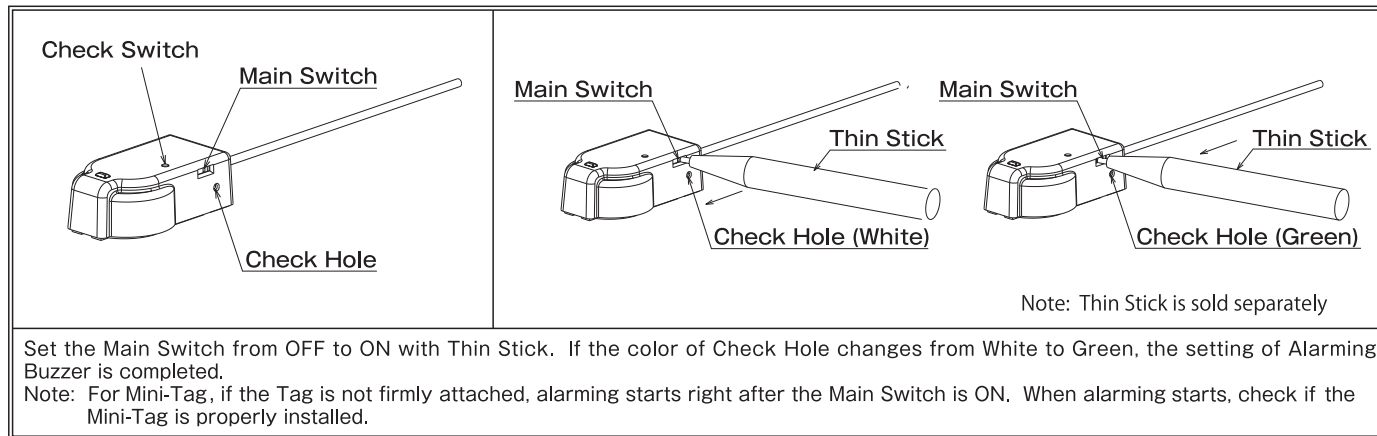

### ▼ Release of Alarming Buzzer

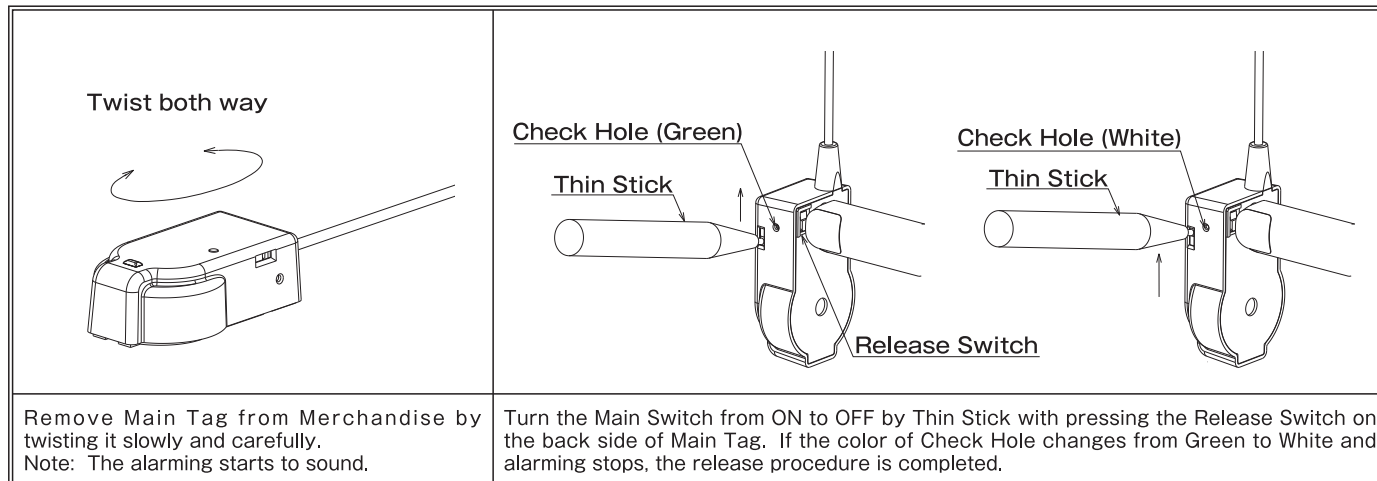

**Note :**

- \* Note that the Main Switch does not move to OFF unless Release Switch is pressed.
- \* In case Alarming Buzzer is set soon again, wait for at least 10 seconds from the release work.
- \* For removing the Tag, twist the Tag slowly and carefully. Removing by strong force or by tools like a screwdriver may possibly damage the Tag.

### ▼ Checking Battery Level (Also can be used to confirm Alarm Buzzer set up.)

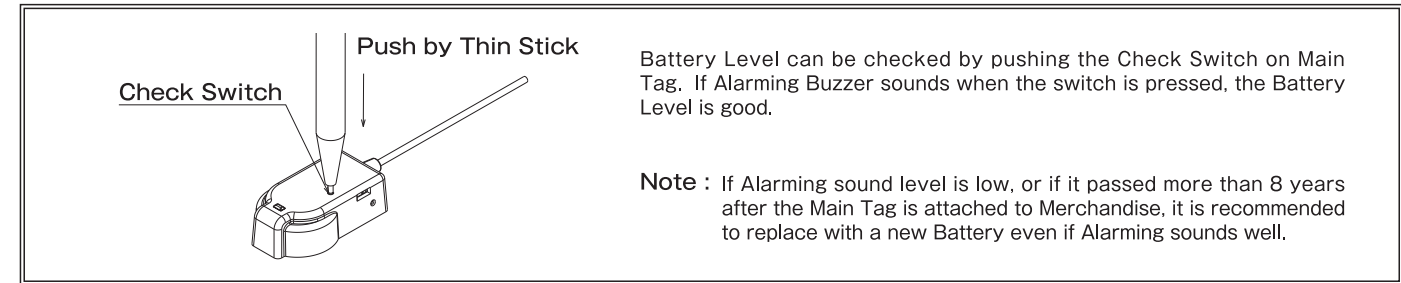

### ▼ Change the Battery (Lithium Battery type CR2032)

